

RECREATION AND OPEN SPACE INVENTORY

A Local Unit which receives a loan or grant from the State of New Jersey, Office of Green Acres shall not dispose of, or divert to a use for other than recreation and conservation purposes, any lands (1) acquired or developed with Green Acres or Federal Land and Water Conservation Fund assistance or (2) held by the Local Unit for recreation and conservation purposes at the "time of receipt of Green Acres funds" (the restricted lands) N.J.S.A. 13:8A-47. The primary purposes of this recreation and open space inventory (ROSI) are to document all restricted lands and to provide notice of the restrictions to title searchers.

Instructions

All restricted lands must be described on the completed ROSI by their block and lot identification numbers as shown on the current, official tax map and specify whether or not each parcel is funded or unfunded parkland. The Local Unit shall submit a tax map current as of the date of Green Acres application showing each parcel of parkland listed on the ROSI, with the approximate boundaries of each such parcel clearly marked in colored ink. Staff knowledgeable of the Local Unit's land use regulations and the uses of its land holdings must complete this ROSI. If only a portion of a current tax lot is to be restricted, the phrase *part of* or *portion of* shall be used on the ROSI. Deletion or omission of lands listed on previously submitted ROSI's is prohibited without prior written approval of the Office of Green Acres (See N.J.A.C. 7:36-20.3).

The completed ROSI must be duly executed and certified by the Local Unit's Chief Executive Officer and planning board chairperson (or equivalent). The page number and the total number of pages in the completed ROSI must be entered at the top right corner of each page.

All pages, including this Page 1 and the following Page 2, of the ROSI must be submitted.

Special Notes

Lands held by school boards, parking authorities, housing authorities, and similar public agencies without primary recreation or conservation responsibilities should not be inventoried unless they are also held for recreation and conservation purposes by the Local Unit.

If lands held by the Local Unit for recreation and conservation purposes are omitted from this ROSI by mistake, inadvertence, or otherwise, such lands shall be subject to the same terms and conditions, covenants, and restrictions as they would be if they were included. This ROSI, as completed and duly executed, shall be incorporated into, and be a part of, both (1) the Green Acres Project Agreement and (2) the Declaration of Encumbrance.

Recommendations

The Local Unit's planning board, and other boards or commissions, are encouraged to participate in the preparation and review of this ROSI. When preparing the ROSI, the listed parcels of parkland should be confirmed by reference to the tax maps that are required to be submitted as part of the Green Acres application (See N.J.A.C. 7:36-6.4(a)3ii or 12.4(a)4ii).

The Local Unit's governing body and planning board should designate, with appropriate descriptive labels, all lands listed on this ROSI in any revision or update of the following master plan elements: recreation plan, conservation plan, and land use plan.

The Local Unit's governing body should officially and permanently dedicate all lands held for recreation and conservation purposes. However, failure to do so shall have no effect on the validity of the Declaration.

Rev. 1/29/99

RECREATION AND OPEN SPACE INVENTORY

Definitions

For the purposes of this ROSI, the following definitions shall apply whenever the quoted words, or a form of the word are used:

"Declaration" means the recordable, written instrument executed by the Local Unit which declares that all of the Local Unit's funded and unfunded parklands are subject to Green Acres restrictions.

"Development" means any improvement or physical alteration designed to expand or enhance the use of parkland for recreation and conservation purposes.

"Funded parkland" means parkland that a Local Unit has acquired or that a Local Unit has developed with Green Acres funding.

"Held" means owned, leased, or otherwise controlled (by the Local Unit for recreation and conservation purposes).

"Lands" means real property, including improvements, rights-of-way, riparian and other rights, easements, privileges, and any other rights or interests in, relating to, or connected with real property.

"Local Unit" means a municipality or county, or other local political subdivision of this State, or any agency thereof whose primary purpose is to acquire, administer, protect, develop, and maintain lands for recreation and conservation purposes.

"Parkland" means land acquired, developed, and/or used for recreation and conservation purposes.

"Recreation and conservation purposes" means the use of lands for parks, natural areas, forests, camping, fishing, reservoirs, water reserves, wildlife preserves, hunting, boating, winter sports and similar uses for either public outdoor recreation or conservation of natural resources, or both, pursuant to the Green Acres Bond Acts. This term also includes the use of historic areas pursuant to P.L. 1974, c.102; P.L. 1978, c.118; P.L. 1983, c.354; P.L. 1987, c.265; P.L. 1989, c.183; P.L. 1992, c.88; and P.L. 1995, c.204; and the use of historic buildings and structures pursuant to P.L. 1992, c.88 and P.L. 1995, c.204; and the use of ecological and biological study areas pursuant to P.L. 1989, c.183; P.L. 1992, c.88; and P.L. 1995, c.204.

"ROSI" mean the listing of all parcels of land held by a Local Unit for recreation and conservation purposes at the time of receipt of Green Acres funds, including a description sufficient to identify each such parcel.

"Time of receipt of Green Acres funds" means at all times beginning on the date of the letter from the Department under N.J.A.C. 7:36-6.7 or 12.5 notifying the Local Unit of the amount of the Green Acres funding award and ending on the date of receipt of the first transmittal of Green Acres funds.

"Unfunded parkland" means parkland, other than funded parkland, that is held by the Local Unit for recreation and conservation purposes at the time of receipt of Green Acres funds.

Legislative References

N.J.S.A. 13:8A-1 et seq.; N.J.S.A. 13:8A-19 et seq.; N.J.S.A. 8:A-35 et seq. (as amended and supplemented); N.J.A.C. 7:36-1 et seq.; 16 U.S.C. 460 s.1 et seq.

RECREATION AND OPEN SPACE INVENTORYLocal Unit: City of Cape May County: Cape May

NOTE: All lands held for recreation and conservation purposes (1) must be described by their block and lot identification numbers as shown on the current, official tax map and (2) keyed to a current, legible, official map of the Local Unit and current tax map of Local Unit. The official map used for this ROSI is named City of Cape May Zoning Map and is dated July 15, 1991.

Developed and Partially Developed Lands Held for Recreation and Conservation Purposes
(*If necessary, use the first page following & after Page 4 for additional developed and partially developed lands)

<u>Key</u>	<u>Municipal Location</u>	<u>Name</u>	<u>Block</u>	<u>Lot</u>	<u>Acres</u>	<u>Funded/Unfunded</u>
1.	City of Cape May	Rotary Park	1045	1-6	0.49	
2.	City of Cape May	Colonial House Park	1059	9	0.24	
3.	City of Cape May	Lafayette St. Playground	1061	51	1.05	
4.	City of Cape May	Harry Lozour Park	1108	1 & 2	0.06	
5.	City of Cape May	Physick Estate Park	1110	8, 14	8.05	
6.	City of Cape May	Wm. Moore Tennis Club	1110	9-11, & 13	3.69	
7.	City of Cape May	Massachusetts Ave. Mini Park	1127	1-2	0.17	
8.	City of Cape May	Penn. & Mich. Mini Park	1114	Adjoins 1	0.10	
9.	City of Cape May	Indiana & Missouri Mini Park	b/t 1125 & 1126		0.10	
10.	City of Cape May	Open Space Median of Cape May Avenue b/t Madison and Pittsburgh Avenues			6.63	
11.	City of Cape May	Fisherman's Memorial	1184	3	0.31	
12.	City of Cape May	Delaware Avenue	1194	1-12	1.89	
13.	City of Cape May	Beachfront	1000	1-26, 28-29.01, 30-33, 35, 37, 38.01 42-49, 51-53.01 56-60, 63.01-65	936.85	
14.	City of Cape May	Beachfront	1221	1, 2, 2.01	6.54	
15.	City of Cape May	Beachfront	1196	1	2.07	
16.	City of Cape May	Beachfront	1219	1-3	2.34	
17.	City of Cape May	Beachfront	1220	1	4.13	

**Property jointly owned by Cape May City, State of New Jersey and the Nature Conservancy

Subtotal of Acres on this page 974.41

Total Acres of developed and partially developed lands from all pages of this ROSI... 974.41

RECREATION AND OPEN SPACE INVENTORY

Local Unit: City of Cape May County: Cape May

NOTE: All lands held for recreation and conservation purposes (1) must be described by their block and lot identification numbers as shown on the current, official tax map and (2) keyed to a current, legible, official map of the Local Unit and current tax map of Local Unit. The official map used for this ROSI is named City of Cape May Zoning Map and is dated July 15, 1991.

Wholly Undeveloped Lands Held for Recreation and Conservation Purposes

(*If necessary, use the second page following & after Page 4 for additional wholly undeveloped lands)

Key	Municipal Location	Name	Block	Lot	Acres
<u>Funded/Unfunded</u>					
A.	City of Cape May	Harborview Park	1173	1	1.27
B.	City of Cape May	The Cape May Nature Center	1184	1, 1.01	4.34
			1195	1, 1.01	3.99
			1206	1, 1.01	3.99
C.	City of Cape May		1001	1	0.01
D.	City of Cape May		1002	1-7	0.7
E.	City of Cape May		1003	1-21	1.4
F.	City of Cape May		1004	1,**2,**3, 4-25	3.56
G.	City of Cape May		1005	1	0.10
H.	City of Cape May		1006	**1-7, 9-23, **24-27	3.54
I.	City of Cape May		*1217	1.01	0.33

*The Cape May Harbor Marina, Inc. conveyed to the Corinthian Yacht Club on 9/04/92 via deed book page 2294/220 a 290' x 400' tract identified as lot 1. Subsequently, the Corinthian Yacht Club conveyed to the City of Cape May on 11/18/96 via deed book page 2692/227 a 50' x 290' tract now identified as lot 1.01. The remaining Corinthian Yacht Club tract is now identified as lot 1.02.

**Property jointly owned by Cape May City, State of New Jersey and the Nature Conservancy

Subtotal of Acres on this page 22.92

Total Acres of wholly undeveloped lands from all pages of this ROSI..... 41.00

CERTIFICATION: I HEREBY CERTIFY that this Exhibit 1 to Declaration, comprising 5 total pages, is a complete and accurate listing of all lands held by the Local Unit, as of this 19th day of May, 2003, for recreation and conservation purposes during the time of receipt of Green Acres funding. This ROSI is being submitted to Green Acres as part of the project entitled Preservation of Sewell Point Tract.

Chief Executive Officer of Local Unit

Date:

Planning Board Chairperson (or equivalent)

Date:

This Certification is to be signed only on this page, Page 4, of EXHIBIT 1 to DECLARATION.

RECREATION AND OPEN SPACE INVENTORY
(Continued)

**Wholly Undeveloped Lands Held for Recreation and Conservation
Purposes**

(* Alphabetical Key)

<u>*Key</u>	<u>Municipal Location</u>	<u>Name</u>	<u>Block</u>	<u>Lot</u>	<u>Acres</u>
<u>Funded/Unfunded</u>					
L.	City of Cape May		1007	1-9	1.51
M.	City of Cape May		1008	**1-6, 7-18, **19-22	3.26
N.	City of Cape May		1009	1-18	3.52
O.	City of Cape May		1010	**1-7, 8-17, **18-22	3.53
P.	City of Cape May		1011	1-10	1.80
Q.	City of Cape May		1012	**1, **18-22	0.89
R.	City of Cape May		1013	1, 2-7, 13-21	2.11
S.	City of Cape May		1015	1	1.4

** Property jointly owned by Cape May City, State of New Jersey and the Nature Conservancy

Subtotal of Acres on this page..... 18.08

REVIEWS	
3-1-2002	CRAS F., READINGTON 23224
1-30-2002	CRAS F., READINGTON 23274
1-30-2003	CRAS F., READINGTON 23284
2-18-2003	CRAS F., READINGTON 23284
8-13-2003	CRAS F., READINGTON 23294
12-13-2003	CRAS F., READINGTON 23294
1-10-2005	CRAS F., READINGTON 23294
1-8-2006	CRAS F., READINGTON 23294
1-10-2007	CRAS F., READINGTON 23294
1-10-2008	CRAS F., READINGTON 23294
1-10-2008	CRAS F., READINGTON 23294

BOROUGH OF WEST CAPE MAY

SEE KEYMAP NO. 2

TOWNSHIP OF LOWER

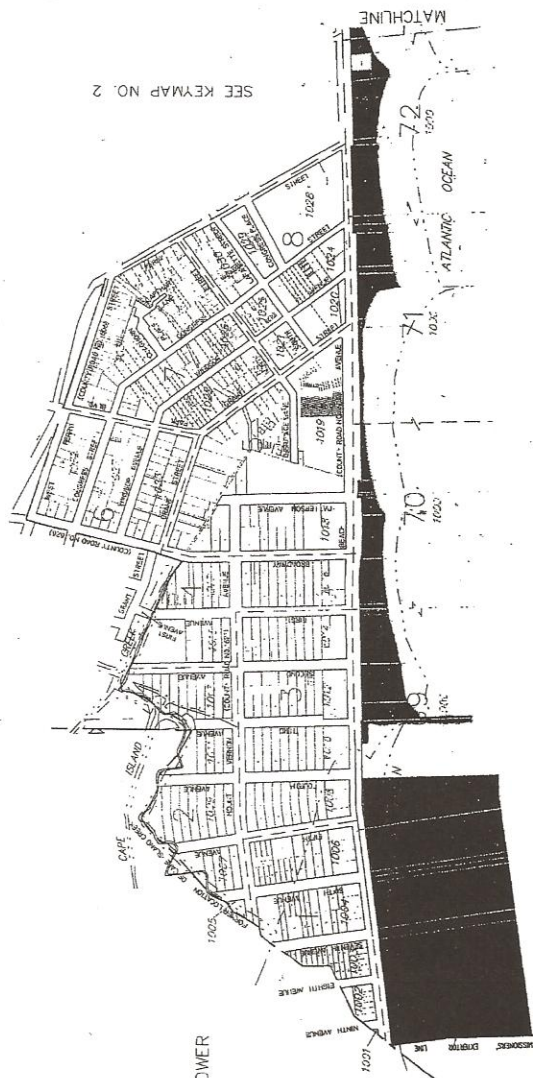

LEGEND

KEY MAP

- [illegible]

THIS TAX WAP PLAT HAS BEEN DETAILED DESIGN
USING COMPUTER-AIDED DRAFTING (CADD) &
COMBINATORIC GEOMETRY (COG) IT IS BASED ON THE
ORIGINAL DETAILING DRAWING TAX WAP PLAT BEARING
THE OFFICIAL NEW JERSEY HIGHWAY TRANSPORTATION
DESIGN NUMBER 624 AND DIMENSIONS OF 200'X100'
JAMES J. COLL, CHIEF, LOCAL ASSOCIATION OF CONTRACTORS,
SAINT C. DOMINIC, SUPERSEDES FIELD
APPROXIMATELY UPDATED TO REFLECT CHANGES AS OF
11-18-2006. THE ORIGINAL DETAILED DESIGN
TAX WAP PLAT WITH THE OFFICIAL APPROVAL STAMP
IS ON FILE WITH ARCHITECT VOROBK & WOLFE
CONSTRUCTION.

KEY MAP NO. 1
CITY OF CAPE MAY
CAPE MAY COUNTY NEW JERSEY

James A. Mott
Professional Engineer & Land Surveyor

MOTT ASSOCIATES, I.L.C.
CONSULTING ENGINEERS & PLANNERS
3122 Fire Road
Egg Harbor Township, New Jersey 08234
(609) 569-1551
New Jersey License No. 29918

KEY MAP NO. 1

REVIEWS	
3-1-2000	CHAS F. RUMFORTH 23874
8-1-2002	CHAS F. RUMFORTH 23874
1-30-2003	CHAS F. RUMFORTH 23974
2-19-2003	CHAS F. RUMFORTH 23974
8-12-2003	CHAS F. RUMFORTH 23574
12-2-2003	CHAS F. RUMFORTH 23874
2-10-2005	CHAS F. RUMFORTH 23974
1-8-2006	CHAS F. RUMFORTH 23974
1-10-2007	CHAS F. RUMFORTH 23874
1-10-2008	CHAS F. RUMFORTH 23874
11-6-2008	CHAS F. RUMFORTH 23974

REVIEWS	
3-1-2003	CHAS F. RUMFORTH 23874
8-1-2002	CHAS F. RUMFORTH 23874
1-30-2003	CHAS F. RUMFORTH 23874
2-18-2003	CHAS F. RUMFORTH 23874
8-12-2003	CHAS F. RUMFORTH 23874
12-2-2003	CHAS F. RUMFORTH 23874
2-10-2006	CHAS F. RUMFORTH 23874
1-8-2004	CHAS F. RUMFORTH 23874
1-10-2007	CHAS F. RUMFORTH 23874
1-10-2008	CHAS F. RUMFORTH 23874
11-16-2008	CHAS F. RUMFORTH 23874

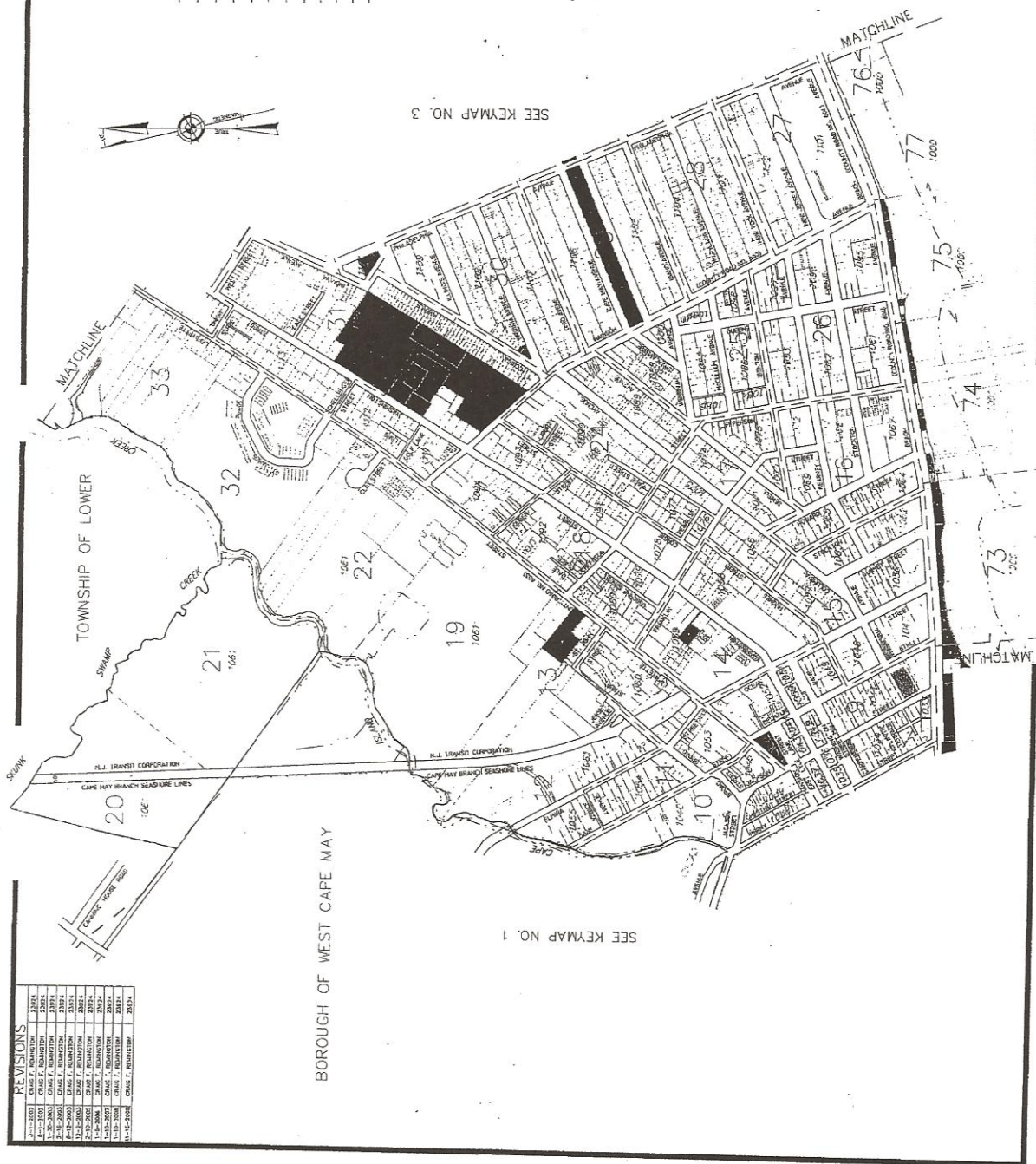

KEY MAP

10
127

WATER LINE
PLATE NUMBER
BLOCK NUMBER
MATCH LINE
PLATE DELINEATION LINE
KEY MAP DELINEATION LINE
MUNICIPAL BOUNDARY LINE
COUNTY BOUNDARY LINE
WATERWAY LINE
ASSESSMENT LINE
TOWNSHIP LINE
WETLAND AREA - WLA
FLOOD HAZARD AREA - FHA
PERCHED OR BULKHEAD LINE
PERCHED OR BULKHEAD LINE

THIS TAX MAP PLATE HAS BEEN DIGITALLY DRAWN USING COMPUTER-AIDED DRAFTING/DESIGN (CADD), A COORDINATE GEOMETRY (COGO), IT IS BASED ON THE ORIGINAL DIGITALLY DRAWN TAX MAP PLATE BEARING THE OFFICIAL NEW JERSEY DESIGN NUMBER TAP-10000. APPROVAL STAMP WITH APPROVAL DATE 3-18-2005 SERIAL NUMBER 846 AND SIGNATURE OF ENGINEER JAMES A. COOL, CHIEF, LOCAL ASSISTANT COMMISSIONER, COUNTY OF COCOS, INCH, 1000, SUPERVISING FIELD ENGINEER, 11-18-2005. THE ORIGINAL DIGITALLY DRAWN TAX MAP PLATE WITH THE OFFICIAL APPROVAL STAMP IS ON FILE WITH REVENUE, OFFICE & MAILING DIVISION.

KEY MAP NO. 2
CITY OF CAPE MAY
CAPE MAY COUNTY NEW JERSEY

DATE: 7-21-2010
Scale: 1" = 300'
James A. Mott
Professional Engineer & Land Surveyor
New Jersey License No. 209116

MOTT ASSOCIATES, LLC
CONSULTING ENGINEERS & PLANNERS
3122 Fite Road
Egg Harbor Township, New Jersey 08234
(609) 505-1551
New Jersey License No. Z2018

KEY MAP NO. 2

REVISIONS		
2-1-2002	CHAS. F. BARNETT	232A
4-1-2002	CHAS. F. BARNETT	232A
5-1-2002	CHAS. F. BARNETT	232A
6-1-2002	CHAS. F. BARNETT	232A
7-1-2002	CHAS. F. BARNETT	232A
8-1-2002	CHAS. F. BARNETT	232A
9-1-2002	CHAS. F. BARNETT	232A
10-1-2002	CHAS. F. BARNETT	232A
11-1-2002	CHAS. F. BARNETT	232A
12-1-2002	CHAS. F. BARNETT	232A
1-1-2003	CHAS. F. BARNETT	232A
2-1-2003	CHAS. F. BARNETT	232A
3-1-2003	CHAS. F. BARNETT	232A
4-1-2003	CHAS. F. BARNETT	232A
5-1-2003	CHAS. F. BARNETT	232A
6-1-2003	CHAS. F. BARNETT	232A
7-1-2003	CHAS. F. BARNETT	232A
8-1-2003	CHAS. F. BARNETT	232A
9-1-2003	CHAS. F. BARNETT	232A
10-1-2003	CHAS. F. BARNETT	232A
11-1-2003	CHAS. F. BARNETT	232A
12-1-2003	CHAS. F. BARNETT	232A



TOWNSHIP OF LOWER

TOWNSHIP OF LOWER

CAPE MAY INLET

ATLANTIC OCEAN

KEY MAP NO. 4
CITY OF CAPE MAY
CAPE MAY COUNTY, NEW JERSEY

SCALE: 1" = 300' DATE: 7-31-2010
JAMES A. MOTI
MOTT ASSOCIATES, LLC
CONSULTING ENGINEERS & PLANNERS
818 Harbor Township, New Jersey 0824
(609) 589-1851

THIS KEY MAP WAS PREPARED BY THE CONSULTING ENGINEERS & PLANNERS, MOTT ASSOCIATES, LLC, FOR THE CITY OF CAPE MAY, NEW JERSEY. THE CITY OF CAPE MAY, NEW JERSEY, IS THE OWNER OF THIS KEY MAP. THE CITY OF CAPE MAY, NEW JERSEY, IS NOT RESPONSIBLE FOR THE ACCURACY OF THE INFORMATION CONTAINED HEREIN. THE CITY OF CAPE MAY, NEW JERSEY, IS NOT RESPONSIBLE FOR THE CONSEQUENCES OF ANY ACTION OR INACTION TAKEN BY ANY PERSON OR ENTITY BASED ON THE INFORMATION CONTAINED HEREIN. THE CITY OF CAPE MAY, NEW JERSEY, IS NOT RESPONSIBLE FOR THE CONSEQUENCES OF ANY ACTION OR INACTION TAKEN BY ANY PERSON OR ENTITY BASED ON THE INFORMATION CONTAINED HEREIN.

U.S. COAST GUARD BASE
TRAINING CENTER

67

OPEN SPACE/PUBLIC PARK

PLATE NUMBER

BLOCK NUMBER

MATCH LINE

PLATE DELINEATION LINE

KEY MAP DELINEATION LINE

MUNICIPAL BOUNDARY LINE

COUNTY BOUNDARY LINE

WATERWAY LINES

ASSESSMENT LINE

TOWNSHIP LINE

WETLAND AREA - W.L.A.

FLOOD HAZARD AREA - F.H.A.

PERICARD OR BULKHEAD LINE

BULKHEAD LINE

10

157

157

157

157

157

157

157

157

157

157

157

157

157

SEE KEYMAP NO. 3

MATCHLINE

BLOCK LIMIT

BUFFALO

AVENUE

AVENUE

AVENUE

AVENUE

AVENUE

AVENUE

AVENUE

AVENUE

AVENUE

AVENUE

AVENUE

AVENUE

AVENUE

AVENUE

AVENUE

AVENUE

AVENUE

AVENUE

AVENUE

AVENUE

AVENUE

AVENUE

AVENUE

AVENUE

AVENUE

AVENUE

AVENUE

AVENUE

AVENUE

AVENUE

AVENUE

AVENUE

AVENUE

AVENUE

AVENUE

AVENUE

AVENUE

AVENUE

AVENUE

AVENUE

AVENUE